

FLAT SIDED FRAME "F"

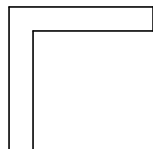

ANGLE*

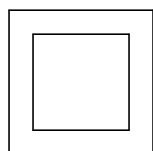

SQUARE TUBE



FLAT BAR

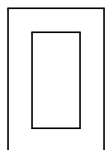

RECTANGULAR TUBE

*PULL-LOCK FITTINGS CANNOT BE USED WITH ANGLE SHAPES OR FLAT BAR IN PITCH APPLICATIONS UNLESS THE POST HOLE IS DRILLED AT THE ANGLE OF THE STAIR RAKE AND A BEVELED WASHER IS USED.

ROUND TUBE FRAME "R"

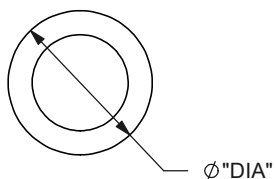

PIPE FRAME "P"

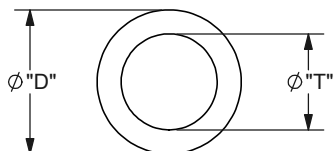

SIZE	"T" THEORETICAL I.D. (PIPE SIZE)	"D" OUTSIDE DIAMETER
1-1/4"	1.25"	1.66"
1-1/2"	1.50"	1.91"
2"	2.00"	2.375"

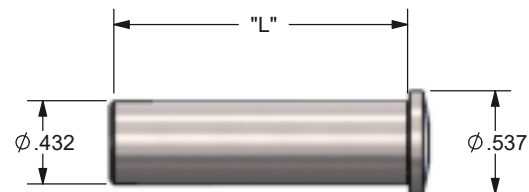

METAL FRAMING OPTIONS FOR PUSH-LOCK FITTINGS					
FRAME "F"	FRAME "R"	FRAME "P"	1/8" CABLE PART NO.	3/16" CABLE PART NO.	"L"
1-1/2"		1-1/4"	PL-4-12	PL-6-12	1.562"
2"		1-1/2"*	PL-4-2.030	PL-6-2.030	2.030"
2-1/2"		2-1/2"	PL-4-2.530	-	2.530"
3"		-	PL-4-3.030	PL-6-3.030	3.030"

*WILL PROTRUDE FROM POST +/- .125"

THE CABLE CONNECTION
 52 HEPPNER DR.
 CARSON CITY, NV 89706
 TOLL FREE: 1-800-851-2961
 PHONE: (775) 885-1443
 FAX: (775) 885-2734
 www.ultra-tec.com

NOTES:

1. INSTALLATION TO BE COMPLETED IN ACCORDANCE WITH MANUFACTURER'S SPECIFICATIONS.
2. THIS DRAWING IS INTENDED FOR USE BY ARCHITECTS, ENGINEERS, CONTRACTORS, CONSULTANTS, AND DESIGN PROFESSIONALS FOR PLANNING PURPOSES ONLY. THIS DRAWING MAY NOT BE USED FOR CONSTRUCTION.
3. ALL INFORMATION CONTAINED HEREIN WAS CURRENT AT THE TIME OF DEVELOPMENT BUT MUST BE REVIEWED AND APPROVED BY THE PRODUCT MANUFACTURER TO BE CONSIDERED ACCURATE.

MATERIAL: 316 SS

PROPRIETARY AND CONFIDENTIAL

THE INFORMATION CONTAINED IN THIS DRAWING IS THE SOLE PROPERTY OF THE CABLE CONNECTION. ANY REPRODUCTION IN PART OR AS A WHOLE WITHOUT THE WRITTEN PERMISSION OF THE CABLE CONNECTION IS PROHIBITED.



**PUSH-LOCK
CABLE RAILING HARDWARE**

SIZE DWG. NO. **A** **SPEC SHEET** REV.

DO NOT SCALE DRAWING SHEET 1 OF 1