

FLAT SIDED FRAME "F"

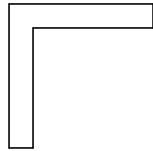

ANGLE*

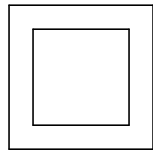

SQUARE TUBE



FLAT BAR

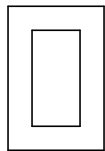

RECTANGULAR TUBE

ROUND TUBE FRAME "R"

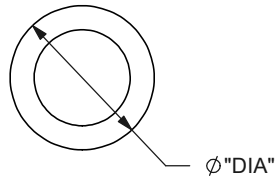

PIPE FRAME "P"

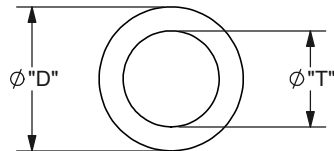

SIZE	"T" THEORETICAL I.D. (PIPE SIZE)	"D" OUTSIDE DIAMETER
1-1/4"	1.25"	1.66"
1-1/2"	1.50"	1.91"
2"	2.00"	2.375"

PUL-4 & PUL-6

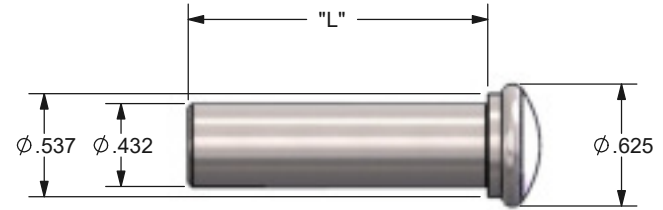

PUL-8

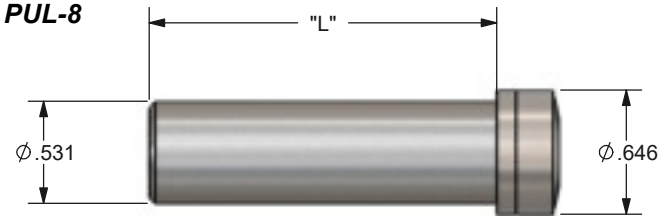

METAL FRAMING OPTIONS FOR PULL-LOCK FITTINGS

FRAME "F"	FRAME "R"	FRAME "P"	1/8" CABLE PART NO.	3/16" CABLE PART NO.	1/4" CABLE PART NO.	"L"
1-1/2"	-	1-1/4"	PUL-4-12	PUL-6-12	-	1.562"
-	-	1-1/2"	PUL-4-1.810	PUL-6-1.810	PUL-8-22	1.810"
2"	-	-	PUL-4-2.030	PUL-6-2.030	PUL-8-32	2.030"
-	-	2"	PUL-4-2.300	PUL-6-2.300	-	2.300"
2-3/8"	-	-	PUL-4-2.375	PUL-6-2.375	-	2.375"
3"	-	-	PUL-4-3.030	PUL-6-3.030	-	3.030"
2-1/2"	-	2-1/2"	PUL-4-2.530	PUL-6-2.530	-	2.530"
3-1/2"	-	3"	PUL-4-3.030	PUL-6-3.030	-	3.030"

THE CABLE CONNECTION

52 HEPNER DR.
CARSON CITY, NV 89706
TOLL FREE: 1-800-851-2961
PHONE: (775) 885-1443
FAX: (775) 885-2734
www.ultra-tec.com



MATERIAL: 316 SS

PROPRIETARY AND CONFIDENTIAL

THE INFORMATION CONTAINED IN THIS DRAWING IS THE SOLE PROPERTY OF THE CABLE CONNECTION. ANY REPRODUCTION IN PART OR AS A WHOLE WITHOUT THE WRITTEN PERMISSION OF THE CABLE CONNECTION IS PROHIBITED.

PULL-LOCK CABLE RAILING HARDWARE
SIZE DWG. NO. **A** **SPEC SHEET** REV. SHEET 1 OF 1

DO NOT SCALE DRAWING

SHEET 1 OF 1

NOTES:

1. INSTALLATION TO BE COMPLETED IN ACCORDANCE WITH MANUFACTURER'S SPECIFICATIONS.
2. THIS DRAWING IS INTENDED FOR USE BY ARCHITECTS, ENGINEERS, CONTRACTORS, CONSULTANTS, AND DESIGN PROFESSIONALS FOR PLANNING PURPOSES ONLY. THIS DRAWING MAY NOT BE USED FOR CONSTRUCTION.
3. ALL INFORMATION CONTAINED HEREIN WAS CURRENT AT THE TIME OF DEVELOPMENT BUT MUST BE REVIEWED AND APPROVED BY THE PRODUCT MANUFACTURER TO BE CONSIDERED ACCURATE.

*PULL-LOCK FITTINGS CANNOT BE USED WITH ANGLE SHAPES OR FLAT BAR IN PITCH APPLICATIONS UNLESS THE POST HOLE IS DRILLED AT THE ANGLE OF THE STAIR RAKE AND A BEVELED WASHER IS USED.